

Unbrako Flat Head Countersunk Socket Screws

Unbrako Flat Head Countersunk Socket Screws are manufactured from high grade alloy steel and held to exacting tolerances to ensure the highest degree of dimensional uniformity. Made stronger and more reliable than competitive product, Unbrako Flat Heads are most commonly used for the fastening of plates, strips, moldings and other thin section parts.

PRODUCT ATTRIBUTES

Flush mounting that enhances the appearance of the product on which they are used.

Closely controlled threads mean tighter, more secure fits, and stronger assemblies.

Deep, accurate socket for uniform wrenching power and high maximum torques.

WHERE YOU WILL FIND OPPORTUNITY

Machine Building	Robotics & Automation
Stamping Presses	Mold Making
Tools Assembly	Heavy Machinery
Conveyer Systems	Electronics

THIS PRODUCT IS OFTEN CALLED...

Flat Head Screw
Flat Head Socket Screw
Countersunk Screw

**Unbrako**

ADDITIONAL UNBRAKO SOCKET PRODUCTS

Socket Head Cap Screws
Socket Low Head Cap Screws
Socket Head Shoulder Screws
Button Head Socket Screws
Flange Button Head Socket Screws
Hardened Ground Machine Dowel Pins
Socket Set Screws
Hexagon Wrenches
Taper Pressure Plugs
Pull Out Dowel Pins

AVAILABLE VALUE ADDED SERVICES

Cross drilling and center drilling
Custom plating

BACKED BY THE EARNEST
Service
GUARANTEE

**The right part.
The right quantity.
On-time.
Everytime.**

UNBRAKO FLAT HEAD COUNTERSUNK SOCKET SCREWS - INCH & METRIC

Unbrako Flat Head Countersunk Socket Screws are manufactured in accordance with the latest revision of the following industry standards:

INCH ASME B18.3 / BS 2470

METRIC DIN 7991 / ISO 10642 / ASME B18.3.5M / BS 4168-8

UNBRAKO FLAT HEAD COUNTERSUNK SOCKET SCREW - INCH

Chemical Composition:

CARBON (C)		PHOSPHORUS (P)	SULFUR (S)
Min	Max	Max	Max
0.30	0.48	0.035	0.040

Alloy

CONTAINS ONE OF THE FOLLOWING ALLOYS
Mn, Cr, Mo, Ni, V

Hardness:

ROCKWELL HARDNESS
HRC 39/43

Tensile Strength

160,000 psi min

*The specifications shown on this sheet are not intended to be used in the production of parts. Earnest Machine is not responsible or liable in any manner for any production errors and we certify the information present on this specification sheet is correct to the best of our knowledge.

©2021 Earnest Machine Products

THREADS

Thread acceptance per ASME B1.3 System 21

INCH Thread requirements per ASME B1.1
Class 3A

METRIC Thread requirements per ISO 261
Class 5g6g

PLATING

Black Oxide

Custom plating available

UNBRAKO FLAT HEAD COUNTERSUNK SOCKET SCREW - METRIC

Chemical Composition:

CARBON (C)		PHOSPHORUS (P)	SULFUR (S)
Min	Max	Max	Max
0.20	0.50	0.035	0.035

Alloy

CONTAINS ONE OF THE FOLLOWING ALLOYS
Mn, Cr, Mo, Ni, V

Hardness:

ROCKWELL HARDNESS
HRC 39/44

Tensile Strength

1040 MPa min

Torque Tightening - Inch

THREAD SIZE	INSTALLATION TORQUE		TENSILE LOAD - MIN	
	UNRC	UNRF	UNRC	UNRF
Nominal				
-	in-lb	in-lb	lbs	lbs
#0	-	1.6	-	265
#1	2.6	2.9	320	320
#2	4.4	4.8	480	480
#3	6.7	8.5	640	800
#4	8.9	10	960	1040
#5	13	14	1120	1280
#6	16	19	1440	1620
#8	30	32	2220	2240
#10	44	51	2780	3180
-	ft-lb	ft-lb	lbs	lbs
1/4	8	10	5070	5790
5/16	18	20	8350	9250
3/8	32	36	12400	14000
7/16	50	57	16900	18900
1/2	78	88	22800	25600
5/8	150	167	3600	40800
3/4	267	297	53200	59300
7/8	450	500	73500	81000
1	683	742	96300	106000

Torque Tightening - Metric

THREAD SIZE	INSTALLATION TORQUE		TENSILE LOAD
	Nm	in-lb	kN
Nominal			
M3	1.4	12	5.28
M4	3.4	30	9.22
M5	6.8	60	14.90
-	-	ft-lb	kN
M6	11.0	8	21.10
M8	28.0	21	38.40
M10	55.0	41	60.90
M12	95.0	70	88.50
M14	150.0	111	121.00
M16	237.0	175	165.00
M18	340.0	250	202.00
M20	480.0	354	257.00
M22	637.0	470	318.00
M24	746.0	550	371.00

*The specifications shown on this sheet are not intended to be used in the production of parts. Earnest Machine is not responsible or liable in any manner for any production errors and we certify the information present on this specification sheet is correct to the best of our knowledge.

©2021 Earnest Machine Products

UNBRAKO FLAT HEAD COUNTERSUNK SOCKET SCREWS - INCH

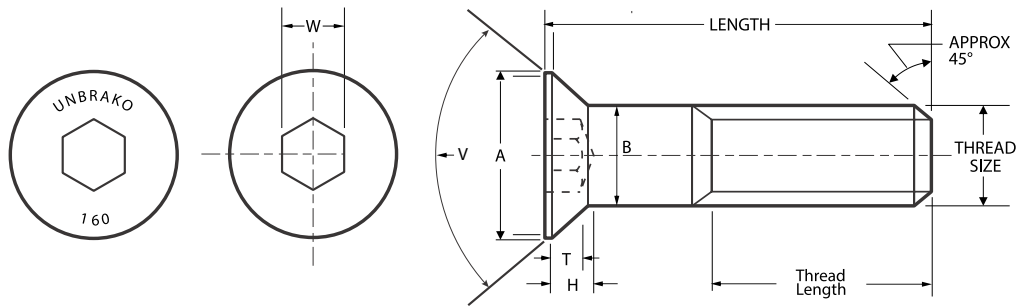

INCH DIMENSIONS

SIZE NOMINAL	THREAD PITCH		HEAD DIAMETER (A)		BODY DIAMETER (B)		SOCKET SIZE (W)	HEAD HEIGHT (H)	SOCKET DEPTH (T)	THREAD LENGTH	HEAD ANGLE (V)
	INCH	UNC	UNF	MAX	MIN	MAX	MIN	NOM.	MAX	MIN	MIN
#0	-	80	0.138	0.117	0.060	0.0568	1/32	0.044	0.025	0.5	82
#1	64	72	0.168	0.143	0.073	0.0695	3/64	0.054	0.031	0.62	82
#2	56	64	0.197	0.168	0.086	0.0822	3/64	0.064	0.038	0.62	82
#3	48	56	0.226	0.193	0.099	0.0949	1/16	0.073	0.044	0.62	82
#4	40	48	0.255	0.218	0.112	0.1075	1/16	0.083	0.055	0.75	82
#5	40	44	0.281	0.240	0.125	0.1202	5/64	0.090	0.061	0.75	82
#6	32	40	0.307	0.263	0.138	0.1329	5/64	0.097	0.066	0.75	82
#8	32	36	0.359	0.311	0.164	0.1585	3/32	0.112	0.076	0.88	82
#10	24	32	0.411	0.359	0.190	0.1840	1/8	0.127	0.087	0.88	82
1/4	20	28	0.531	0.480	0.250	0.2435	5/32	0.161	0.111	1	82
5/16	18	24	0.656	0.600	0.3125	0.3053	3/16	0.198	0.135	1.12	82
3/8	16	24	0.781	0.720	0.375	0.3678	7/32	0.234	0.159	1.25	82
7/16	14	20	0.844	0.781	0.4375	0.4294	1/4	0.234	0.159	1.38	82
1/2	13	20	0.938	0.872	0.500	0.4919	5/16	0.251	0.172	1.5	82
5/8	11	18	1.188	1.112	0.625	0.6163	3/8	0.324	0.220	1.75	82
3/4	10	16	1.438	1.355	0.750	0.7406	1/2	0.396	0.220	2	82
7/8	9	14	1.688	1.604	0.875	0.8647	9/16	0.468	0.248	2.25	82
1	8	12	1.938	1.841	1.000	0.9886	5/8	0.540	0.297	2.5	82

*The specifications shown on this sheet are not intended to be used in the production of parts. Earnest Machine is not responsible or liable in any manner for any production errors and we certify the information present on this specification sheet is correct to the best of our knowledge.

©2021 Earnest Machine Products

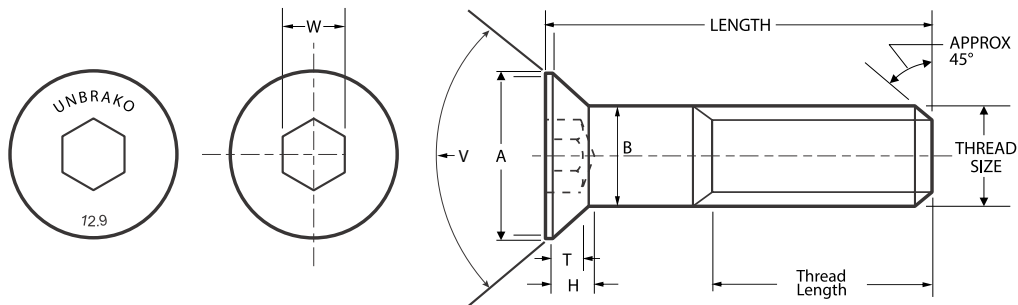
UNBRAKO FLAT HEAD SOCKET CAP SCREWS - METRIC DIMENSIONS

METRIC DIMENSIONS

SIZE NOMINAL	THREAD PITCH	HEAD DIAMETER (A)		BODY DIAMETER (B)		SOCKET SIZE (W)	HEAD HEIGHT (H)	SOCKET DEPTH (T)	THREAD LENGTH	HEAD ANGLE (V)
		MAX	MIN	MAX	MIN					
M3	0.50	6.0	5.82	3.0	2.86	2.0	1.86	1.2	3.12	90
M4	0.70	8.0	7.80	4.0	3.82	2.5	2.48	1.8	3.44	90
M5	0.80	10.0	9.78	5.0	4.82	3.0	3.10	2.3	3.75	90
M6	1.00	12.0	11.73	6.0	5.82	4.0	3.72	2.5	24	90
M8	1.25	16.0	15.73	8.0	7.78	5.0	4.96	3.5	28	90
M10	1.50	20.0	19.67	10.0	9.78	6.0	6.20	4.4	32	90
M12	1.75	24.0	23.67	12.0	11.73	8.0	7.44	4.6	36	90
M14	2.00	27.0	26.67	14.0	13.73	10.0	8.12	4.8	40	90
M16	2.00	30.0	29.67	16.0	15.73	10.0	8.80	5.3	44	90
M18	2.50	33.0	32.61	18.0	17.73	12.0	9.48	5.5	48	90
M20	2.50	36.0	35.61	20.0	19.67	12.0	10.11	5.9	52	90
M22	2.50	36.0	35.61	22.0	21.67	14.0	13.32	8.8	56	90
M24	3.00	39.0	38.61	24.0	23.67	14.0	14.22	10.3	60	60

*The specifications shown on this sheet are not intended to be used in the production of parts. Earnest Machine is not responsible or liable in any manner for any production errors and we certify the information present on this specification sheet is correct to the best of our knowledge.

©2021 Earnest Machine Products

Unbrako Flat Head Countersunk Socket Screws - Inch

SIZE	THREAD	PITCH	MATERIAL	FINISH	UNBRAKO PART #	EARNEST PART #
#4-40x1/4	Full	Coarse	Alloy Steel	Black Oxide	104414	961000
#4-40x3/8	Full	Coarse	Alloy Steel	Black Oxide	104447	961006
#4-40x1/2	Full	Coarse	Alloy Steel	Black Oxide	104480	960997
#4-40x5/8	Full	Coarse	Alloy Steel	Black Oxide	103424	961009
#4-40x3/4	Full	Coarse	Alloy Steel	Black Oxide	103457	961003

#5-40x1/4	Full	Coarse	Alloy Steel	Black Oxide	121026	961015
#5-40x3/8	Full	Coarse	Alloy Steel	Black Oxide	107506	961021
#5-40x1/2	Full	Coarse	Alloy Steel	Black Oxide	107615	961012
#5-40x5/8	Full	Coarse	Alloy Steel	Black Oxide	113269	961024
#5-40x3/4	Full	Coarse	Alloy Steel	Black Oxide	119592	961018

#6-32x1/4	Full	Coarse	Alloy Steel	Black Oxide	119626	961033
#6-32x3/8	Full	Coarse	Alloy Steel	Black Oxide	119658	961039
#6-32x1/2	Full	Coarse	Alloy Steel	Black Oxide	119691	961030
#6-32x5/8	Full	Coarse	Alloy Steel	Black Oxide	119725	961042
#6-32x3/4	Full	Coarse	Alloy Steel	Black Oxide	119759	961036
#6-32x1	Full	Coarse	Alloy Steel	Black Oxide	105351	961027

#8-32x3/8	Full	Coarse	Alloy Steel	Black Oxide	106645	961054
#8-32x1/2	Full	Coarse	Alloy Steel	Black Oxide	106677	961048
#8-32x5/8	Full	Coarse	Alloy Steel	Black Oxide	106709	961057
#8-32x3/4	Full	Coarse	Alloy Steel	Black Oxide	106741	961051
#8-32x1	Full	Coarse	Alloy Steel	Black Oxide	106773	961045

#10-24x3/8	Full	Coarse	Alloy Steel	Black Oxide	106805	960970
#10-24x1/2	Full	Coarse	Alloy Steel	Black Oxide	113654	960964
#10-24x5/8	Full	Coarse	Alloy Steel	Black Oxide	113687	960973
#10-24x3/4	Full	Coarse	Alloy Steel	Black Oxide	113719	960967
#10-24x1	Full	Coarse	Alloy Steel	Black Oxide	120686	960955
#10-24x1-1/4	Full	Coarse	Alloy Steel	Black Oxide	118712	960958
#10-24x1-1/2	Partial	Coarse	Alloy Steel	Black Oxide	108955	960961

#10-32x3/8	Full	Fine	Alloy Steel	Black Oxide	111890	960991
#10-32x1/2	Full	Fine	Alloy Steel	Black Oxide	111889	960985
#10-32x5/8	Full	Fine	Alloy Steel	Black Oxide	113158	960994
#10-32x3/4	Full	Fine	Alloy Steel	Black Oxide	107655	960988
#10-32x1	Full	Fine	Alloy Steel	Black Oxide	107671	960976
#10-32x1-1/4	Full	Fine	Alloy Steel	Black Oxide	107687	960979
#10-32x1-1/2	Partial	Fine	Alloy Steel	Black Oxide	111818	960982



Unbrako Flat Head Countersunk Socket Screws - Inch

SIZE	THREAD	PITCH	MATERIAL	FINISH	UNBRAKO PART #	EARNEST PART #
1/4-20x3/8	Full	Coarse	Alloy Steel	Black Oxide	105257	960721
1/4-20x1/2	Full	Coarse	Alloy Steel	Black Oxide	105289	960715
1/4-20x5/8	Full	Coarse	Alloy Steel	Black Oxide	105321	960724
1/4-20x3/4	Full	Coarse	Alloy Steel	Black Oxide	105352	960718
1/4-20x1	Full	Coarse	Alloy Steel	Black Oxide	118658	960700
1/4-20x1-1/4	Full	Coarse	Alloy Steel	Black Oxide	120514	960703
1/4-20x1-1/2	Full	Coarse	Alloy Steel	Black Oxide	120581	960706
1/4-20x1-3/4	Partial	Coarse	Alloy Steel	Black Oxide	120645	960709
1/4-20x2	Partial	Coarse	Alloy Steel	Black Oxide	118672	960712

1/4-28x3/8	Full	Fine	Alloy Steel	Black Oxide	111834	960742
1/4-28x1/2	Full	Fine	Alloy Steel	Black Oxide	108107	960736
1/4-28x5/8	Full	Fine	Alloy Steel	Black Oxide	104289	960745
1/4-28x3/4	Full	Fine	Alloy Steel	Black Oxide	104322	960739
1/4-28x1	Full	Fine	Alloy Steel	Black Oxide	104356	960727
1/4-28x1-1/4	Full	Fine	Alloy Steel	Black Oxide	115174	960730
1/4-28x1-1/2	Full	Fine	Alloy Steel	Black Oxide	107581	960733

5/16-18x1/2	Full	Coarse	Alloy Steel	Black Oxide	120341	960769
5/16-18x5/8	Full	Coarse	Alloy Steel	Black Oxide	119485	960775
5/16-18x3/4	Full	Coarse	Alloy Steel	Black Oxide	119517	960772
5/16-18x7/8	Full	Coarse	Alloy Steel	Black Oxide	106770	960778
5/16-18x1	Full	Coarse	Alloy Steel	Black Oxide	105918	960748
5/16-18x1-1/4	Full	Coarse	Alloy Steel	Black Oxide	105951	960751
5/16-18x1-1/2	Full	Coarse	Alloy Steel	Black Oxide	105983	960754
5/16-18x1-3/4	Full	Coarse	Alloy Steel	Black Oxide	106015	960757
5/16-18x2	Partial	Coarse	Alloy Steel	Black Oxide	106046	960760
5/16-18x2-1/4	Partial	Coarse	Alloy Steel	Black Oxide	106079	960763
5/16-18x2-1/2	Partial	Coarse	Alloy Steel	Black Oxide	117115	960766

5/16-24x1/2	Full	Fine	Alloy Steel	Black Oxide	114970	960790
5/16-24x5/8	Full	Fine	Alloy Steel	Black Oxide	103930	960796
5/16-24x3/4	Full	Fine	Alloy Steel	Black Oxide	103326	960793
5/16-24x1	Full	Fine	Alloy Steel	Black Oxide	115218	960781
5/16-24x1-1/4	Full	Fine	Alloy Steel	Black Oxide	115282	960784
5/16-24x1-1/2	Full	Fine	Alloy Steel	Black Oxide	115345	960787

Unbrako Flat Head Countersunk Socket Screws - Inch

SIZE	THREAD	PITCH	MATERIAL	FINISH	UNBRAKO PART #	EARNEST PART #
3/8-16x1/2	Full	Coarse	Alloy Steel	Black Oxide	117147	960823
3/8-16x5/8	Full	Coarse	Alloy Steel	Black Oxide	117179	960829
3/8-16x3/4	Full	Coarse	Alloy Steel	Black Oxide	107104	960826
3/8-16x7/8	Full	Coarse	Alloy Steel	Black Oxide	118253	960832
3/8-16x1	Full	Coarse	Alloy Steel	Black Oxide	107136	960799
3/8-16x1-1/4	Full	Coarse	Alloy Steel	Black Oxide	104272	960802
3/8-16x1-1/2	Full	Coarse	Alloy Steel	Black Oxide	104338	960805
3/8-16x1-3/4	Full	Coarse	Alloy Steel	Black Oxide	110464	960808
3/8-16x2	Full	Coarse	Alloy Steel	Black Oxide	108160	960811
3/8-16x2-1/4	Partial	Coarse	Alloy Steel	Black Oxide	109890	960814
3/8-16x2-1/2	Partial	Coarse	Alloy Steel	Black Oxide	103706	960817
3/8-16x3	Partial	Coarse	Alloy Steel	Black Oxide	104929	960820

3/8-24x5/8	Full	Fine	Alloy Steel	Black Oxide	115416	960847
3/8-24x3/4	Full	Fine	Alloy Steel	Black Oxide	103388	960844
3/8-24x1	Full	Fine	Alloy Steel	Black Oxide	103420	960835
3/8-24x1-1/4	Full	Fine	Alloy Steel	Black Oxide	106866	960838
3/8-24x1-1/2	Full	Fine	Alloy Steel	Black Oxide	106896	960841

7/16-14x3/4	Full	Coarse	Alloy Steel	Black Oxide	104993	960865
7/16-14x1	Full	Coarse	Alloy Steel	Black Oxide	116833	960850
7/16-14x1-1/4	Full	Coarse	Alloy Steel	Black Oxide	116897	960853
7/16-14x1-1/2	Full	Coarse	Alloy Steel	Black Oxide	102033	960856
7/16-14x1-3/4	Full	Coarse	Alloy Steel	Black Oxide	105097	960859
7/16-14x2	Full	Coarse	Alloy Steel	Black Oxide	116228	960862

1/2-13x3/4	Full	Coarse	Alloy Steel	Black Oxide	115671	960892
1/2-13x1	Full	Coarse	Alloy Steel	Black Oxide	102630	960868
1/2-13x1-1/4	Full	Coarse	Alloy Steel	Black Oxide	107321	960871
1/2-13x1-1/2	Full	Coarse	Alloy Steel	Black Oxide	107353	960874
1/2-13x1-3/4	Full	Coarse	Alloy Steel	Black Oxide	120801	960877
1/2-13x2	Full	Coarse	Alloy Steel	Black Oxide	106977	960880
1/2-13x2-1/4	Full	Coarse	Alloy Steel	Black Oxide	106992	960883
1/2-13x2-1/2	Partial	Coarse	Alloy Steel	Black Oxide	107007	960886
1/2-13x3	Partial	Coarse	Alloy Steel	Black Oxide	107038	960889

1/2-20x3/4	Full	Fine	Alloy Steel	Black Oxide	106925	960910
1/2-20x1	Full	Fine	Alloy Steel	Black Oxide	106955	960895
1/2-20x1-1/4	Full	Fine	Alloy Steel	Black Oxide	106985	960898
1/2-20x1-1/2	Full	Fine	Alloy Steel	Black Oxide	107015	960901
1/2-20x1-3/4	Full	Fine	Alloy Steel	Black Oxide	107046	960904
1/2-20x2	Full	Fine	Alloy Steel	Black Oxide	107076	960907

Unbrako Flat Head Countersunk Socket Screws - Inch

SIZE	THREAD	PITCH	MATERIAL	FINISH	UNBRAKO PART #	EARNEST PART #
5/8-11x1-1/4	Full	Coarse	Alloy Steel	Black Oxide	107053	960913
5/8-11x1-1/2	Full	Coarse	Alloy Steel	Black Oxide	107923	960916
5/8-11x1-3/4	Full	Coarse	Alloy Steel	Black Oxide	120818	960919
5/8-11x2	Full	Coarse	Alloy Steel	Black Oxide	107955	960922
5/8-11x2-1/4	Full	Coarse	Alloy Steel	Black Oxide	107971	960925
5/8-11x2-1/2	Full	Coarse	Alloy Steel	Black Oxide	107989	960928
5/8-11x3	Full	Coarse	Alloy Steel	Black Oxide	120848	960931

3/4-10x1-1/4	Full	Coarse	Alloy Steel	Black Oxide	102419	960934
3/4-10x1-1/2	Full	Coarse	Alloy Steel	Black Oxide	102436	960937
3/4-10x1-3/4	Full	Coarse	Alloy Steel	Black Oxide	102453	960940
3/4-10x2	Full	Coarse	Alloy Steel	Black Oxide	102469	960943
3/4-10x2-1/4	Full	Coarse	Alloy Steel	Black Oxide	102486	960946
3/4-10x2-1/2	Full	Coarse	Alloy Steel	Black Oxide	102502	960949
3/4-10x3	Full	Coarse	Alloy Steel	Black Oxide	102535	960952

Unbrako Flat Head Countersunk Socket Screws - Inch

SIZE	THREAD	PITCH	CLASS	FINISH	UNBRAKO PART #	EARNEST PART #
M3-0.5x6	Full	Coarse	ISO 12.9	Black Oxide	106283	961204
M3-0.5x8	Full	Coarse	ISO 12.9	Black Oxide	103303	961207
M3-0.5x10	Full	Coarse	ISO 12.9	Black Oxide	103304	961210
M3-0.5x12	Full	Coarse	ISO 12.9	Black Oxide	103305	961213
M3-0.5x15	Full	Coarse	ISO 12.9	Black Oxide	401672	961216
M3-0.5x16	Full	Coarse	ISO 12.9	Black Oxide	103306	961219
M3-0.5x20	Full	Coarse	ISO 12.9	Black Oxide	103308	961222
M3-0.5x25	Full	Coarse	ISO 12.9	Black Oxide	106284	961225
M3-0.5x30	Full	Coarse	ISO 12.9	Black Oxide	106285	961228

M4-0.7x8	Full	Coarse	ISO 12.9	Black Oxide	103309	961231
M4-0.7x10	Full	Coarse	ISO 12.9	Black Oxide	103311	961234
M4-0.7x12	Full	Coarse	ISO 12.9	Black Oxide	103312	961237
M4-0.7x15	Full	Coarse	ISO 12.9	Black Oxide	401674	961240
M4-0.7x16	Full	Coarse	ISO 12.9	Black Oxide	103313	961243
M4-0.7x18	Full	Coarse	ISO 12.9	Black Oxide	401675	961246
M4-0.7x20	Full	Coarse	ISO 12.9	Black Oxide	103315	961249
M4-0.7x25	Full	Coarse	ISO 12.9	Black Oxide	103316	961252
M4-0.7x30	Full	Coarse	ISO 12.9	Black Oxide	103317	961255
M4-0.7x35	Partial	Coarse	ISO 12.9	Black Oxide	106287	961258
M4-0.7x40	Partial	Coarse	ISO 12.9	Black Oxide	106288	961261

Unbrako Flat Head Countersunk Socket Screws - Metric

SIZE	THREAD	PITCH	MATERIAL	FINISH	UNBRAKO PART #	EARNEST PART #
M5-0.8x8	Full	Coarse	ISO 12.9	Black Oxide	103318	961264
M5-0.8x10	Full	Coarse	ISO 12.9	Black Oxide	103319	961267
M5-0.8x12	Full	Coarse	ISO 12.9	Black Oxide	103320	961270
M5-0.8x14	Full	Coarse	ISO 12.9	Black Oxide	401676	961273
M5-0.8x15	Full	Coarse	ISO 12.9	Black Oxide	401660	961276
M5-0.8x16	Full	Coarse	ISO 12.9	Black Oxide	103321	961279
M5-0.8x18	Full	Coarse	ISO 12.9	Black Oxide	401677	961282
M5-0.8x20	Full	Coarse	ISO 12.9	Black Oxide	103322	961285
M5-0.8x25	Full	Coarse	ISO 12.9	Black Oxide	103323	961288
M5-0.8x30	Full	Coarse	ISO 12.9	Black Oxide	103324	961291
M5-0.8x35	Full	Coarse	ISO 12.9	Black Oxide	106289	961294
M5-0.8x40	Partial	Coarse	ISO 12.9	Black Oxide	106290	961297
M5-0.8x45	Partial	Coarse	ISO 12.9	Black Oxide	106293	961300
M5-0.8x50	Partial	Coarse	ISO 12.9	Black Oxide	106294	961303

M6-1.0x8	Full	Coarse	ISO 12.9	Black Oxide	103325	961306
M6-1.0x10	Full	Coarse	ISO 12.9	Black Oxide	103328	961309
M6-1.0x12	Full	Coarse	ISO 12.9	Black Oxide	103329	961312
M6-1.0x14	Full	Coarse	ISO 12.9	Black Oxide	401678	961315
M6-1.0x15	Full	Coarse	ISO 12.9	Black Oxide	401661	961318
M6-1.0x16	Full	Coarse	ISO 12.9	Black Oxide	103330	961321
M6-1.0x18	Full	Coarse	ISO 12.9	Black Oxide	401679	961324
M6-1.0x20	Full	Coarse	ISO 12.9	Black Oxide	103331	961327
M6-1.0x25	Full	Coarse	ISO 12.9	Black Oxide	103332	961330
M6-1.0x30	Full	Coarse	ISO 12.9	Black Oxide	103333	961333
M6-1.0x35	Full	Coarse	ISO 12.9	Black Oxide	103334	961336
M6-1.0x40	Full	Coarse	ISO 12.9	Black Oxide	103335	961339
M6-1.0x45	Partial	Coarse	ISO 12.9	Black Oxide	106295	961342
M6-1.0x50	Partial	Coarse	ISO 12.9	Black Oxide	106296	961345

M8-1.25 x10	Full	Coarse	ISO 12.9	Black Oxide	103336	961348
M8-1.25 x12	Full	Coarse	ISO 12.9	Black Oxide	103337	961351
M8-1.25 x15	Full	Coarse	ISO 12.9	Black Oxide	401680	961354
M8-1.25 x16	Full	Coarse	ISO 12.9	Black Oxide	103338	961357
M8-1.25 x18	Full	Coarse	ISO 12.9	Black Oxide	401681	961360
M8-1.25 x20	Full	Coarse	ISO 12.9	Black Oxide	103340	961363
M8-1.25 x25	Full	Coarse	ISO 12.9	Black Oxide	103341	961366
M8-1.25 x30	Full	Coarse	ISO 12.9	Black Oxide	103342	961369
M8-1.25 x35	Full	Coarse	ISO 12.9	Black Oxide	103343	961372
M8-1.25 x40	Full	Coarse	ISO 12.9	Black Oxide	103344	961375
M8-1.25 x45	Full	Coarse	ISO 12.9	Black Oxide	106297	961378
M8-1.25 x50	Partial	Coarse	ISO 12.9	Black Oxide	106298	961381
M8-1.25 x55	Partial	Coarse	ISO 12.9	Black Oxide	106299	961384
M8-1.25 x60	Partial	Coarse	ISO 12.9	Black Oxide	106300	961387
M8-1.25 x70	Partial	Coarse	ISO 12.9	Black Oxide	106301	961390

Unbrako Flat Head Countersunk Socket Screws - Inch

SIZE	THREAD	PITCH	MATERIAL	FINISH	UNBRAKO PART #	EARNEST PART #
M10-1.5x12	Full	Coarse	ISO 12.9	Black Oxide	103345	961060
M10-1.5x16	Full	Coarse	ISO 12.9	Black Oxide	103347	961063
M10-1.5x20	Full	Coarse	ISO 12.9	Black Oxide	103348	961066
M10-1.5x25	Full	Coarse	ISO 12.9	Black Oxide	103349	961069
M10-1.5x30	Full	Coarse	ISO 12.9	Black Oxide	103350	961072
M10-1.5x35	Full	Coarse	ISO 12.9	Black Oxide	103351	961075
M10-1.5x40	Full	Coarse	ISO 12.9	Black Oxide	103352	961078
M10-1.5x45	Full	Coarse	ISO 12.9	Black Oxide	106302	961081
M10-1.5x50	Full	Coarse	ISO 12.9	Black Oxide	106303	961084
M10-1.5x55	Full	Coarse	ISO 12.9	Black Oxide	106304	961087
M10-1.5x60	Partial	Coarse	ISO 12.9	Black Oxide	106305	961090
M10-1.5x70	Partial	Coarse	ISO 12.9	Black Oxide	106306	961093
M10-1.5x80	Partial	Coarse	ISO 12.9	Black Oxide	106308	961096
M10-1.5x90	Partial	Coarse	ISO 12.9	Black Oxide	106309	961099
M10-1.5x100	Partial	Coarse	ISO 12.9	Black Oxide	106310	961102

M12-1.75x20	Full	Coarse	ISO 12.9	Black Oxide	103353	961105
M12-1.75x25	Full	Coarse	ISO 12.9	Black Oxide	103354	961108
M12-1.75x30	Full	Coarse	ISO 12.9	Black Oxide	103355	961111
M12-1.75x35	Full	Coarse	ISO 12.9	Black Oxide	103356	961114
M12-1.75x40	Full	Coarse	ISO 12.9	Black Oxide	103357	961117
M12-1.75x45	Full	Coarse	ISO 12.9	Black Oxide	106311	961120
M12-1.75x50	Full	Coarse	ISO 12.9	Black Oxide	103358	961123
M12-1.75x55	Full	Coarse	ISO 12.9	Black Oxide	106312	961126
M12-1.75x60	Full	Coarse	ISO 12.9	Black Oxide	106313	961129
M12-1.75x70	Partial	Coarse	ISO 12.9	Black Oxide	106314	961132
M12-1.75x80	Partial	Coarse	ISO 12.9	Black Oxide	106315	961135
M12-1.75x90	Partial	Coarse	ISO 12.9	Black Oxide	106316	961138
M12-1.75x100	Partial	Coarse	ISO 12.9	Black Oxide	106330	961141

M16-2.0x30	Full	Coarse	ISO 12.9	Black Oxide	103359	961144
M16-2.0x35	Full	Coarse	ISO 12.9	Black Oxide	103360	961147
M16-2.0x40	Full	Coarse	ISO 12.9	Black Oxide	103361	961150
M16-2.0x45	Full	Coarse	ISO 12.9	Black Oxide	106318	961153
M16-2.0x50	Full	Coarse	ISO 12.9	Black Oxide	103362	961156
M16-2.0x55	Full	Coarse	ISO 12.9	Black Oxide	106320	961159
M16-2.0x60	Full	Coarse	ISO 12.9	Black Oxide	103363	961162
M16-2.0x70	Full	Coarse	ISO 12.9	Black Oxide	106321	961165
M16-2.0x80	Partial	Coarse	ISO 12.9	Black Oxide	106322	961168



Unbrako Flat Head Countersunk Socket Screws - Metric

SIZE	THREAD	PITCH	MATERIAL	FINISH	UNBRAKO PART #	EARNEST PART #
M20-2.5x35	Full	Coarse	ISO 12.9	Black Oxide	106328	961171
M20-2.5x40	Full	Coarse	ISO 12.9	Black Oxide	106332	961174
M20-2.5x45	Full	Coarse	ISO 12.9	Black Oxide	106334	961177
M20-2.5x50	Full	Coarse	ISO 12.9	Black Oxide	106335	961180
M20-2.5x60	Full	Coarse	ISO 12.9	Black Oxide	106337	961183
M20-2.5x70	Full	Coarse	ISO 12.9	Black Oxide	106338	961186
M20-2.5x80	Full	Coarse	ISO 12.9	Black Oxide	106339	961189
M20-2.5x100	Full	Coarse	ISO 12.9	Black Oxide	106342	961192
M20-2.5x120	Partial	Coarse	ISO 12.9	Black Oxide	401685	961195
M20-2.5x140	Partial	Coarse	ISO 12.9	Black Oxide	401686	961198
M20-2.5x160	Partial	Coarse	ISO 12.9	Black Oxide	401687	961201