



Unbrako Button Head Socket Screws

Unbrako Button Head Socket Screws offer a low profile head that creates a smooth appearance when installed. These screws have deep sockets that ensure non-slip wrench engagements and are recommended for use in applications that are made from materials which are too thin to countersink.

PRODUCT ATTRIBUTES

Button Heads offer a larger bearing face that provides additional support to thinner and softer materials.

Precision forged head for continuous grain flow and maximum strength.

Controlled heat treatment for maximum uniform strength and surface integrity without brittleness or decarburization.

WHERE YOU WILL FIND OPPORTUNITY

| | |
|-----------------------|------------------|
| Robotics & Automation | Machine Building |
| Tools Assembly | Aerospace |
| Petrochemical | Heavy Machinery |
| Military | Electronics |

THIS PRODUCT IS OFTEN CALLED...

Button Head
Button Head Socket Cap Screw
Hex Socket Button Head
Button Head Hex Socket Screw

**Unbrako.**

ADDITIONAL UNBRAKO SOCKET PRODUCTS

Socket Head Cap Screws
Socket Low Head Cap Screws
Socket Head Shoulder Screws
Flat Head Countersunk Socket Screws
Flange Button Head Socket Screws
Hardened Ground Machine Dowel Pins
Socket Set Screws
Hexagon Wrenches
Taper Pressure Plugs
Pull Out Dowel Pins

AVAILABLE VALUE ADDED SERVICES

Secondary & rework services available
Custom plating
Guaranteed distribution

BACKED BY THE EARNEST

Service
GUARANTEE**The right part.
The right quantity.
On-time.
Everytime.**

UNBRAKO BUTTON HEAD SOCKET SCREWS - INCH & METRIC

Unbrako Button Head Socket Screws are manufactured in accordance with the latest revision of the following industry standards:

INCH ASME B18.3

METRIC ISO 7380
ASME B18.3.4M

UNBRAKO BUTTON HEAD SOCKET SCREW - INCH
Chemical Composition:

| CARBON (C) | | PHOSPHORUS (P) | SULFUR (S) |
|------------|------|----------------|------------|
| Min | Max | Max | Max |
| 0.30 | 0.48 | 0.035 | 0.040 |

Alloy

| CONTAINS ONE OF THE FOLLOWING ALLOYS |
|--------------------------------------|
| Mn, Cr, Mo, Ni, V |

Hardness:

| ROCKWELL HARDNESS |
|-------------------|
| HRC 38/43 |

Tensile Strength

| |
|-----------------|
| 160,000 psi min |
|-----------------|

Torque Tightening - Inch

| THREAD SIZE | INSTALLATION TORQUE | | TENSILE LOAD - MIN | |
|-------------|---------------------|-------|--------------------|-------|
| | UNRC | UNRF | UNRC | UNRF |
| Nominal | in-lb | in-lb | lbs | lbs |
| - | | | | |
| #4 | 8.9 | 10 | 960 | 1040 |
| #5 | 13 | 14 | 1120 | 1280 |
| #6 | 16 | 19 | 1440 | 1620 |
| #8 | 30 | 32 | 2220 | 2240 |
| #10 | 44 | 51 | 2780 | 3180 |
| 1/4 | 100 | 120 | 5070 | 5790 |
| 5/16 | 210 | 240 | 8350 | 9250 |
| 3/8 | 380 | 430 | 12400 | 14000 |
| 7/16 | 600 | 680 | 16900 | 18900 |
| 1/2 | 930 | 1050 | 22800 | 25600 |
| 5/8 | 1800 | 2000 | 36000 | 40800 |
| 3/4 | 3200 | 3560 | 53200 | 59300 |

THREADS

Thread acceptance per ASME B1.3 System 21

INCH Thread requirements per ASME B1.1
Class 3A

METRIC Thread requirements per ISO 261
Class 5g6g

PLATING

Black Oxide (thermal black oxide)
Custom coatings available

UNBRAKO BUTTON HEAD SOCKET SCREW - METRIC
Chemical Composition:

| CARBON (C) | | PHOSPHORUS (P) | SULFUR (S) |
|------------|------|----------------|------------|
| Min | Max | Max | Max |
| 0.20 | 0.50 | 0.035 | 0.035 |

Alloy

| CONTAINS ONE OF THE FOLLOWING ALLOYS |
|--------------------------------------|
| Mn, Cr, Mo, Ni, V |

Hardness:

| ROCKWELL HARDNESS |
|-------------------|
| HRC 33/39 |

Tensile Strength: 12.9

| |
|--------------|
| 1040 MPa min |
|--------------|

Torque Tightening - Metric

| THREAD SIZE | INSTALLATION TORQUE | | TENSILE LOAD |
|-------------|---------------------|-------|--------------|
| | Nm | in-lb | kN |
| Nominal | | | |
| M3 | 1.4 | 12 | 5.28 |
| M4 | 3.4 | 30 | 9.22 |
| M5 | 6.8 | 60 | 14.90 |
| M6 | 11.0 | 97 | 21.10 |
| M8 | 28.0 | 248 | 38.40 |
| M10 | 55.0 | 486 | 60.90 |
| M12 | 95.0 | 840 | 88.50 |

*The specifications shown on this sheet are not intended to be used in the production of parts. Earnest Machine is not responsible or liable in any manner for any production errors and we certify the information present on this specification sheet is correct to the best of our knowledge.

©2021 Earnest Machine Products

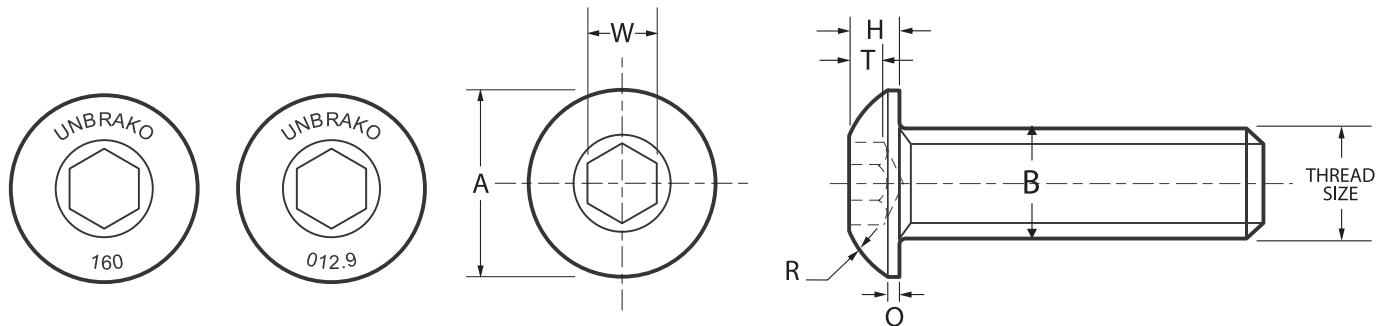
UNBRAKO BUTTON HEAD SOCKET SCREWS - INCH & METRIC DIMENSIONS

INCH DIMENSIONS

| THREAD SIZE (B) | THREADS PER INCH | | HEAD DIAMETER (A) | | HEAD HEIGHT (H) | | SOCKET DEPTH (T) | Q | R | HEX SOCKET SIZE (W) | |
|-----------------|------------------|-----|-------------------|-------|-----------------|-------|------------------|-------|-------|---------------------|------|
| | Nominal | UNC | UNF | MAX | MIN | MAX | MIN | MIN | MAX | REF | MIN |
| #0 | - | 80 | | 0.114 | 0.104 | 0.032 | 0.026 | 0.020 | 0.010 | 0.070 | 1/32 |
| #1 | 64 | 72 | | 0.139 | 0.129 | 0.039 | 0.033 | 0.028 | 0.010 | 0.080 | 3/64 |
| #2 | 56 | 64 | | 0.164 | 0.154 | 0.046 | 0.038 | 0.028 | 0.010 | 0.099 | 3/64 |
| #3 | 48 | 56 | | 0.188 | 0.176 | 0.052 | 0.044 | 0.035 | 0.010 | 0.110 | 1/16 |
| #4 | 40 | 48 | | 0.213 | 0.201 | 0.059 | 0.051 | 0.035 | 0.015 | 0.135 | 1/16 |
| #5 | 40 | 44 | | 0.238 | 0.226 | 0.066 | 0.058 | 0.044 | 0.015 | 0.141 | 5/64 |
| #6 | 32 | 40 | | 0.262 | 0.250 | 0.073 | 0.063 | 0.044 | 0.015 | 0.158 | 5/64 |
| #8 | 32 | 36 | | 0.312 | 0.298 | 0.087 | 0.077 | 0.052 | 0.015 | 0.185 | 3/32 |
| #10 | 24 | 32 | | 0.361 | 0.347 | 0.101 | 0.091 | 0.070 | 0.020 | 0.213 | 1/8 |
| 1/4 | 20 | 28 | | 0.437 | 0.419 | 0.132 | 0.122 | 0.087 | 0.031 | 0.249 | 5/32 |
| 5/16 | 18 | 24 | | 0.547 | 0.527 | 0.166 | 0.152 | 0.105 | 0.031 | 0.309 | 3/16 |
| 3/8 | 16 | 24 | | 0.656 | 0.636 | 0.199 | 0.185 | 0.122 | 0.031 | 0.368 | 7/32 |
| 7/16 | 14 | 20 | | 0.750 | 0.730 | 0.232 | 0.212 | 0.138 | 0.31 | 0.417 | 1/4 |
| 1/2 | 13 | 20 | | 0.875 | 0.851 | 0.265 | 0.245 | 0.175 | 0.046 | 0.481 | 5/16 |
| 5/8 | 11 | 18 | | 1.000 | 0.970 | 0.331 | 0.311 | 0.210 | 0.062 | 0.523 | 3/8 |
| 3/4 | 10 | 16 | | 1.218 | 1.198 | 0.398 | 0.378 | 0.272 | 0.78 | 0z.670 | 1/2 |

METRIC DIMENSIONS

| THREAD SIZE (B) | THREAD PITCH | HEAD DIAMETER (A) | HEAD HEIGHT (H) | SOCKET DEPTH (T) | Q | R | HEX SOCKET SIZE (W) |
|-----------------|--------------|-------------------|-----------------|------------------|------|-------|---------------------|
| Nominal | UNC | MAX | REF | MIN | MAX | REF | Nominal |
| M3 | 0.50 | 5.70 | 1.65 | 1.04 | 0.38 | 3.00 | 2.0 |
| M4 | 0.70 | 7.60 | 2.20 | 1.3 | 0.38 | 4.20 | 2.5 |
| M5 | 0.80 | 9.50 | 2.75 | 1.56 | 0.50 | 5.20 | 3.0 |
| M6 | 1.00 | 10.50 | 3.30 | 2.08 | 0.80 | 5.60 | 4.0 |
| M8 | 1.25 | 14.00 | 4.40 | 2.6 | 0.80 | 7.50 | 5.0 |
| M10 | 1.50 | 17.50 | 5.50 | 3.12 | 0.80 | 10.00 | 6.0 |
| M12 | 1.75 | 21.00 | 6.60 | 4.16 | 0.80 | 11.00 | 8.0 |

*The specifications shown on this sheet are not intended to be used in the production of parts. Earnest Machine is not responsible or liable in any manner for any production errors and we certify the information present on this specification sheet is correct to the best of our knowledge. ©2021 Earnest Machine Products

Unbrako Button Head Socket Screws - Inch

| SIZE | THREAD | PITCH | MATERIAL | FINISH | UNBRAKO PART # | EARNEST PART # |
|------------|--------|--------|-------------|-------------|----------------|----------------|
| #4-40x1/4 | Full | Coarse | Alloy Steel | Black Oxide | 104704 | 960252 |
| #4-40x5/16 | Full | Coarse | Alloy Steel | Black Oxide | 107146 | 960258 |
| #4-40x3/8 | Full | Coarse | Alloy Steel | Black Oxide | 104720 | 960255 |
| #4-40x1/2 | Full | Coarse | Alloy Steel | Black Oxide | 104736 | 960249 |

| | | | | | | |
|------------|------|--------|-------------|-------------|--------|--------|
| #6-32x1/4 | Full | Coarse | Alloy Steel | Black Oxide | 104752 | 960267 |
| #6-32x5/16 | Full | Coarse | Alloy Steel | Black Oxide | 105496 | 960273 |
| #6-32x3/8 | Full | Coarse | Alloy Steel | Black Oxide | 104768 | 960270 |
| #6-32x1/2 | Full | Coarse | Alloy Steel | Black Oxide | 104784 | 960264 |
| #6-32x5/8 | Full | Coarse | Alloy Steel | Black Oxide | 104800 | 960276 |
| #6-32x1 | Full | Coarse | Alloy Steel | Black Oxide | 106565 | 960261 |

| | | | | | | |
|-----------|------|--------|-------------|-------------|--------|--------|
| #8-32x1/4 | Full | Coarse | Alloy Steel | Black Oxide | 116546 | 960288 |
| #8-32x3/8 | Full | Coarse | Alloy Steel | Black Oxide | 116562 | 960297 |
| #8-32x1/2 | Full | Coarse | Alloy Steel | Black Oxide | 116579 | 960282 |
| #8-32x5/8 | Full | Coarse | Alloy Steel | Black Oxide | 116595 | 960300 |
| #8-32x3/4 | Full | Coarse | Alloy Steel | Black Oxide | 116611 | 960291 |

| | | | | | | |
|------------|------|--------|-------------|-------------|--------|--------|
| #10-24x1/4 | Full | Coarse | Alloy Steel | Black Oxide | 116932 | 960192 |
| #10-24x3/8 | Full | Coarse | Alloy Steel | Black Oxide | 116948 | 960204 |
| #10-24x1/2 | Full | Coarse | Alloy Steel | Black Oxide | 116964 | 960189 |
| #10-24x5/8 | Full | Coarse | Alloy Steel | Black Oxide | 109705 | 960207 |
| #10-24x3/4 | Full | Coarse | Alloy Steel | Black Oxide | 109722 | 960195 |
| #10-24x7/8 | Full | Coarse | Alloy Steel | Black Oxide | 103523 | 960213 |
| #10-24x1 | Full | Coarse | Alloy Steel | Black Oxide | 103539 | 960183 |

| | | | | | | |
|------------|------|------|-------------|-------------|--------|--------|
| #10-32x1/4 | Full | Fine | Alloy Steel | Black Oxide | 105400 | 960225 |
| #10-32x3/8 | Full | Fine | Alloy Steel | Black Oxide | 102042 | 960234 |
| #10-32x1/2 | Full | Fine | Alloy Steel | Black Oxide | 102058 | 960219 |
| #10-32x5/8 | Full | Fine | Alloy Steel | Black Oxide | 120709 | 960243 |
| #10-32x3/4 | Full | Fine | Alloy Steel | Black Oxide | 120725 | 960231 |
| #10-32x7/8 | Full | Fine | Alloy Steel | Black Oxide | 120741 | 960246 |
| #10-32x1 | Full | Fine | Alloy Steel | Black Oxide | 118647 | 960216 |

| | | | | | | |
|--------------|------|--------|-------------|-------------|--------|--------|
| 1/4-20x3/8 | Full | Coarse | Alloy Steel | Black Oxide | 103556 | 960024 |
| 1/4-20x1/2 | Full | Coarse | Alloy Steel | Black Oxide | 110416 | 960012 |
| 1/4-20x5/8 | Full | Coarse | Alloy Steel | Black Oxide | 104174 | 960030 |
| 1/4-20x3/4 | Full | Coarse | Alloy Steel | Black Oxide | 104191 | 960018 |
| 1/4-20x7/8 | Full | Coarse | Alloy Steel | Black Oxide | 104209 | 960033 |
| 1/4-20x1 | Full | Coarse | Alloy Steel | Black Oxide | 103943 | 960003 |
| 1/4-20x1-1/4 | Full | Coarse | Alloy Steel | Black Oxide | 120415 | 960006 |
| 1/4-20x1-1/2 | Full | Coarse | Alloy Steel | Black Oxide | 120447 | 960009 |

Unbrako Button Head Socket Screws - Inch

| SIZE | THREAD | PITCH | MATERIAL | FINISH | UNBRAKO PART # | EARNEST PART # |
|------------|--------|-------|-------------|-------------|----------------|----------------|
| 1/4-28x1/4 | Full | Fine | Alloy Steel | Black Oxide | 114974 | 960042 |
| 1/4-28x3/8 | Full | Fine | Alloy Steel | Black Oxide | 118664 | 960048 |
| 1/4-28x1/2 | Full | Fine | Alloy Steel | Black Oxide | 120494 | 960039 |
| 1/4-28x5/8 | Full | Fine | Alloy Steel | Black Oxide | 120527 | 960051 |
| 1/4-28x3/4 | Full | Fine | Alloy Steel | Black Oxide | 120561 | 960045 |
| 1/4-28x7/8 | Full | Fine | Alloy Steel | Black Oxide | 120593 | 960054 |
| 1/4-28x1 | Full | Fine | Alloy Steel | Black Oxide | 120625 | 960036 |

| | | | | | | |
|---------------|------|--------|-------------|-------------|--------|--------|
| 5/16-18x3/8 | Full | Coarse | Alloy Steel | Black Oxide | 103959 | 960078 |
| 5/16-18x1/2 | Full | Coarse | Alloy Steel | Black Oxide | 103975 | 960066 |
| 5/16-18x5/8 | Full | Coarse | Alloy Steel | Black Oxide | 103991 | 960084 |
| 5/16-18x3/4 | Full | Coarse | Alloy Steel | Black Oxide | 104007 | 960072 |
| 5/16-18x7/8 | Full | Coarse | Alloy Steel | Black Oxide | 104023 | 960090 |
| 5/16-18x1 | Full | Coarse | Alloy Steel | Black Oxide | 104040 | 960057 |
| 5/16-18x1-1/4 | Full | Coarse | Alloy Steel | Black Oxide | 119263 | 960063 |

| | | | | | | |
|-------------|------|------|-------------|-------------|--------|--------|
| 5/16-24x3/8 | Full | Fine | Alloy Steel | Black Oxide | 701879 | 960093 |
| 5/16-24x1/2 | Full | Fine | Alloy Steel | Black Oxide | 120690 | 960099 |
| 5/16-24x5/8 | Full | Fine | Alloy Steel | Black Oxide | 118684 | 960105 |
| 5/16-24x3/4 | Full | Fine | Alloy Steel | Black Oxide | 118716 | 960102 |
| 5/16-24x1 | Full | Fine | Alloy Steel | Black Oxide | 120320 | 960096 |

| | | | | | | |
|--------------|------|--------|-------------|-------------|--------|--------|
| 3/8-16x1/2 | Full | Coarse | Alloy Steel | Black Oxide | 104056 | 960126 |
| 3/8-16x5/8 | Full | Coarse | Alloy Steel | Black Oxide | 104072 | 960138 |
| 3/8-16x3/4 | Full | Coarse | Alloy Steel | Black Oxide | 108180 | 960132 |
| 3/8-16x7/8 | Full | Coarse | Alloy Steel | Black Oxide | 108197 | 960141 |
| 3/8-16x1 | Full | Coarse | Alloy Steel | Black Oxide | 108213 | 960108 |
| 3/8-16x1-1/4 | Full | Coarse | Alloy Steel | Black Oxide | 108229 | 960114 |
| 3/8-16x1-1/2 | Full | Coarse | Alloy Steel | Black Oxide | 113752 | 960120 |
| 3/8-16x2 | Full | Coarse | Alloy Steel | Black Oxide | 701845 | 960123 |

| | | | | | | |
|--------------|------|------|-------------|-------------|--------|--------|
| 3/8-24x1/2 | Full | Fine | Alloy Steel | Black Oxide | 120353 | 960150 |
| 3/8-24x3/4 | Full | Fine | Alloy Steel | Black Oxide | 119491 | 960153 |
| 3/8-24x1 | Full | Fine | Alloy Steel | Black Oxide | 119523 | 960144 |
| 3/8-24x1 1/4 | Full | Fine | Alloy Steel | Black Oxide | 183934 | 960147 |

| | | | | | | |
|--------------|------|--------|-------------|-------------|--------|--------|
| 1/2-13x3/4 | Full | Coarse | Alloy Steel | Black Oxide | 106017 | 960168 |
| 1/2-13x1 | Full | Coarse | Alloy Steel | Black Oxide | 111721 | 960156 |
| 1/2-13x1-1/4 | Full | Coarse | Alloy Steel | Black Oxide | 111737 | 960159 |
| 1/2-13x1-1/2 | Full | Coarse | Alloy Steel | Black Oxide | 111753 | 960162 |
| 1/2-13x2 | Full | Coarse | Alloy Steel | Black Oxide | 111769 | 960165 |

Unbrako Button Head Socket Screws - Inch

| SIZE | THREAD | PITCH | MATERIAL | FINISH | UNBRAKO PART # | EARNEST PART # |
|--------------|--------|--------|-------------|-------------|----------------|----------------|
| 1/2-13x3/4 | Full | Coarse | Alloy Steel | Black Oxide | 106017 | 960168 |
| 1/2-13x1 | Full | Coarse | Alloy Steel | Black Oxide | 111721 | 960156 |
| 1/2-13x1-1/4 | Full | Coarse | Alloy Steel | Black Oxide | 111737 | 960159 |
| 1/2-13x1-1/2 | Full | Coarse | Alloy Steel | Black Oxide | 111753 | 960162 |
| 1/2-13x2 | Full | Coarse | Alloy Steel | Black Oxide | 111769 | 960165 |

| | | | | | | |
|----------|------|------|-------------|-------------|--------|--------|
| 1/2-20x1 | Full | Fine | Alloy Steel | Black Oxide | 108196 | 960171 |
|----------|------|------|-------------|-------------|--------|--------|

| | | | | | | |
|--------------|------|--------|-------------|-------------|--------|--------|
| 5/8-11x1-1/4 | Full | Coarse | Alloy Steel | Black Oxide | 111802 | 960174 |
| 5/8-11x1-1/2 | Full | Coarse | Alloy Steel | Black Oxide | 111819 | 960177 |
| 5/8-11x2 | Full | Coarse | Alloy Steel | Black Oxide | 111906 | 960180 |

Unbrako Button Head Socket Screws - Metric

| SIZE | THREAD | PITCH | CLASS | FINISH | UNBRAKO PART # | EARNEST PART # |
|-----------|--------|--------|----------|-------------|----------------|----------------|
| M3-0.5x5 | Full | Coarse | ISO 12.9 | Black Oxide | 180248 | 960354 |
| M3-0.5x6 | Full | Coarse | ISO 12.9 | Black Oxide | 106353 | 960357 |
| M3-0.5x8 | Full | Coarse | ISO 12.9 | Black Oxide | 106354 | 960363 |
| M3-0.5x10 | Full | Coarse | ISO 12.9 | Black Oxide | 106357 | 960366 |
| M3-0.5x12 | Full | Coarse | ISO 12.9 | Black Oxide | 106358 | 960369 |
| M3-0.5x16 | Full | Coarse | ISO 12.9 | Black Oxide | 106359 | 960372 |

| | | | | | | |
|-----------|------|--------|----------|-------------|--------|--------|
| M4-0.7x6 | Full | Coarse | ISO 12.9 | Black Oxide | 180200 | 960375 |
| M4-0.7x8 | Full | Coarse | ISO 12.9 | Black Oxide | 106360 | 960378 |
| M4-0.7x10 | Full | Coarse | ISO 12.9 | Black Oxide | 106361 | 960384 |
| M4-0.7x12 | Full | Coarse | ISO 12.9 | Black Oxide | 106363 | 960390 |
| M4-0.7x15 | Full | Coarse | ISO 12.9 | Black Oxide | 401218 | 960396 |
| M4-0.7x16 | Full | Coarse | ISO 12.9 | Black Oxide | 106364 | 960399 |

| | | | | | | |
|-----------|------|--------|----------|-------------|--------|--------|
| M5-0.8x6 | Full | Coarse | ISO 12.9 | Black Oxide | 180398 | 960405 |
| M5-0.8x8 | Full | Coarse | ISO 12.9 | Black Oxide | 180175 | 960408 |
| M5-0.8x10 | Full | Coarse | ISO 12.9 | Black Oxide | 106365 | 960411 |
| M5-0.8x12 | Full | Coarse | ISO 12.9 | Black Oxide | 106366 | 960417 |
| M5-0.8x15 | Full | Coarse | ISO 12.9 | Black Oxide | 401219 | 960423 |
| M5-0.8x16 | Full | Coarse | ISO 12.9 | Black Oxide | 106367 | 960426 |
| M5-0.8x18 | Full | Coarse | ISO 12.9 | Black Oxide | 406269 | 960432 |
| M5-0.8x20 | Full | Coarse | ISO 12.9 | Black Oxide | 106368 | 960435 |
| M5-0.8x22 | Full | Coarse | ISO 12.9 | Black Oxide | 401220 | 960441 |
| M5-0.8x25 | Full | Coarse | ISO 12.9 | Black Oxide | 106369 | 960444 |
| M5-0.8x30 | Full | Coarse | ISO 12.9 | Black Oxide | 106370 | 960450 |

Unbrako Button Head Socket Screws - Metric

| SIZE | THREAD | PITCH | CLASS | FINISH | UNBRAKO PART # | EARNEST PART # |
|-----------|--------|--------|----------|-------------|----------------|----------------|
| M6-1.0x8 | Full | Coarse | ISO 12.9 | Black Oxide | 180249 | 960453 |
| M6-1.0x10 | Full | Coarse | ISO 12.9 | Black Oxide | 106372 | 960456 |
| M6-1.0x12 | Full | Coarse | ISO 12.9 | Black Oxide | 106373 | 960462 |
| M6-1.0x15 | Full | Coarse | ISO 12.9 | Black Oxide | 401222 | 960468 |
| M6-1.0x16 | Full | Coarse | ISO 12.9 | Black Oxide | 106374 | 960471 |
| M6-1.0x18 | Full | Coarse | ISO 12.9 | Black Oxide | 401223 | 960477 |
| M6-1.0x20 | Full | Coarse | ISO 12.9 | Black Oxide | 106375 | 960480 |
| M6-1.0x25 | Full | Coarse | ISO 12.9 | Black Oxide | 106376 | 960486 |
| M6-1.0x30 | Full | Coarse | ISO 12.9 | Black Oxide | 106378 | 960492 |

| | | | | | | |
|-------------|------|--------|----------|-------------|--------|--------|
| M8-1.25 x10 | Full | Coarse | ISO 12.9 | Black Oxide | 106379 | 960498 |
| M8-1.25 x12 | Full | Coarse | ISO 12.9 | Black Oxide | 106380 | 960504 |
| M8-1.25 x15 | Full | Coarse | ISO 12.9 | Black Oxide | 401226 | 960510 |
| M8-1.25 x16 | Full | Coarse | ISO 12.9 | Black Oxide | 106382 | 960513 |
| M8-1.25 x20 | Full | Coarse | ISO 12.9 | Black Oxide | 106384 | 960519 |
| M8-1.25x25 | Full | Coarse | ISO 12.9 | Black Oxide | 106385 | 960525 |
| M8-1.25x30 | Full | Coarse | ISO 12.9 | Black Oxide | 106386 | 960531 |
| M8-1.25x35 | Full | Coarse | ISO 12.9 | Black Oxide | 106389 | 960537 |
| M8-1.25x40 | Full | Coarse | ISO 12.9 | Black Oxide | 106390 | 960540 |

| | | | | | | |
|------------|------|--------|----------|-------------|--------|--------|
| M10-1.5x16 | Full | Coarse | ISO 12.9 | Black Oxide | 106392 | 960303 |
| M10-1.5x20 | Full | Coarse | ISO 12.9 | Black Oxide | 106393 | 960309 |
| M10-1.5x25 | Full | Coarse | ISO 12.9 | Black Oxide | 106396 | 960315 |
| M10-1.5x30 | Full | Coarse | ISO 12.9 | Black Oxide | 106399 | 960321 |
| M10-1.5x35 | Full | Coarse | ISO 12.9 | Black Oxide | 106401 | 960327 |
| M10-1.5x40 | Full | Coarse | ISO 12.9 | Black Oxide | 106402 | 960330 |

| | | | | | | |
|-------------|------|--------|----------|-------------|--------|--------|
| M12-1.75x16 | Full | Coarse | ISO 12.9 | Black Oxide | 106403 | 960333 |
| M12-1.75x20 | Full | Coarse | ISO 12.9 | Black Oxide | 106404 | 960336 |
| M12-1.75x25 | Full | Coarse | ISO 12.9 | Black Oxide | 106405 | 960339 |
| M12-1.75x30 | Full | Coarse | ISO 12.9 | Black Oxide | 106406 | 960342 |
| M12-1.75x35 | Full | Coarse | ISO 12.9 | Black Oxide | 106407 | 960345 |
| M12-1.75x40 | Full | Coarse | ISO 12.9 | Black Oxide | 106408 | 960348 |
| M12-1.75x50 | Full | Coarse | ISO 12.9 | Black Oxide | 106413 | 960351 |